

**Line pulls from
15,000 lb to 72,000 lb
(67 kN to 321 kN))**

This catalogue contains detailed sales information on the Lantec LH Series Hoists.
With 12 basic models, a modular design and flexible input options,
LANTEC LH Series Hoists suit many applications.



Experience

LANTEC is a name you can trust.

For over 40 years, LANTEC has been designing and building very reliable and robust hoists, winches and planetary gear drive products for the offshore drilling and production market.

LANTEC offers hoists and planetary drives for the offshore industry certified to various regulatory bodies, including API (American Petroleum Institute), ABS (American Bureau of Shipping), and DNV (Det Norsk Veritas).

Why Choose LANTEC?

LANTEC puts reliability above all else.

LANTEC saves money in the long term.

LANTEC builds a superior hoist in every detail.

LANTEC provides the security and peace of mind that comes from knowing you've purchased the most cost effective and reliable hoist available for your demanding application.

What makes a
LANTEC LH Series Hoist
superior to the competition?

The answer is in the engineering details.
Explore the benefits of LANTEC's feature rich design on the following pages.

reliability versatility quality

The dimensions shown are for general information. Only a detailed Certified Installation Drawing, specific to your hoist, should be used for final installation dimensions. Certified Installation Drawings are available from LANTEC upon request.

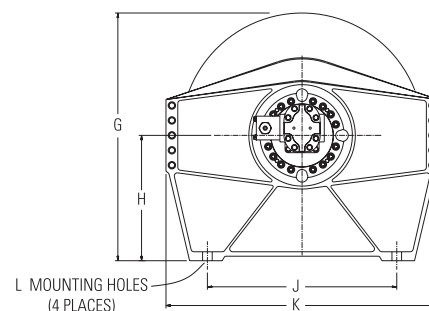
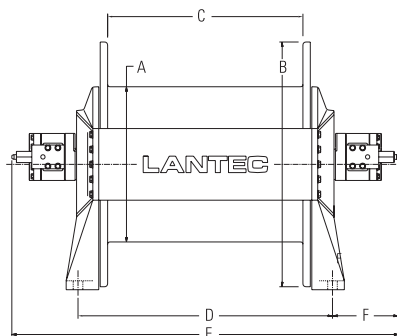

Dimensions E and F are based on the Standard Motor. Length will vary with optional motors.

Specifications subject to change without notice and without incurring obligation. Rely only on a Certified Installation Drawing for accurate and current dimensions.

Model	Drum Number	Barrel Diameter	Flange Diameter	Between Flanges	Mounting Holes	Length	Mounting Offset	Height	Height to Center	Mounting Holes	Width	Mounting Hole Diameter
		A	B	C	D	E	F	G	H	J	K	L
LHD Series – Dual Drive												
<i>All dimensions are in inches.</i>												
LHD200	01	15.00	23.00	23.63	33.13	57.85	12.36	23.38	11.88	14.75	27.00	1.06
	02	14.00	27.50	23.88	32.75	56.97	12.11	28.00	14.25	21.00	31.25	1.06
	03	14.00	27.50	30.88	39.75	63.97	12.11	28.00	14.25	21.00	31.25	1.06
	04	14.00	33.00	30.00	37.40	59.20	10.90	33.50	17.00	20.00	36.75	1.38
	05	14.00	33.00	37.25	44.65	66.45	10.90	33.50	17.00	20.00	36.75	1.38
LHD310	01	17.00	23.00	24.50	33.88	58.10	12.11	25.75	14.25	21.00	31.25	1.06
	02	18.00	27.50	24.88	34.25	58.47	12.11	28.00	14.25	21.00	31.25	1.31
	03	18.00	27.50	30.88	40.25	64.47	12.11	28.00	14.25	21.00	31.25	1.06
	04	18.00	33.00	30.00	41.79	63.59	10.90	33.50	17.00	20.00	36.75	1.38
	05	18.00	33.00	37.25	49.04	70.84	10.90	33.50	17.00	20.00	36.75	1.38
LHD450	01	20.00	27.50	37.25	51.75	77.61	12.93	29.75	16.00	8 Bolts Consult Factory	34.50	1.38
	02	20.00	27.50	55.13	69.63	95.49	12.93	29.75	16.00		34.50	1.38
	03	18.00	33.00	32.13	46.63	72.49	12.93	35.25	18.75		40.00	1.38
	04	18.00	33.00	36.63	51.13	76.99	12.93	35.25	18.75		40.00	1.38
	05	18.00	33.00	54.50	69.00	94.86	12.93	35.25	18.75		40.00	1.38
LHD670	01	22.00	33.00	36.38	50.88	76.74	12.93	35.25	18.75	8 Bolts Consult Factory	40.00	1.38
	02	22.00	33.00	54.25	68.75	94.61	12.93	35.25	18.75		40.00	1.38
	03	22.00	38.00	31.38	45.88	71.74	12.93	40.25	21.25		45.00	1.38
	04	22.00	38.00	35.88	50.38	76.24	12.93	40.25	21.25		45.00	1.38
	05	22.00	38.00	53.75	68.25	94.11	12.93	40.25	21.25		45.00	1.38
LHD840	01	22.00	33.00	36.38	50.41	72.21	10.90	33.50	17.00	20.00	36.75	1.38
	02	22.00	38.00	35.88	50.88	76.74	12.93	40.25	21.25	8 Bolts Consult Factory	45.00	1.38
	03	22.00	42.00	35.63	51.63	77.49	12.93	46.25	25.25		49.00	1.38
	04	22.00	42.00	53.50	69.50	95.36	12.93	46.25	25.25		49.00	1.38
	05	22.00	46.00	35.38	51.38	77.24	12.93	52.25	29.25		53.00	1.38