

## F600 ABF

### OPERATING CONDITIONS

Refrigerant **Freon**

Refrigerant  
Inlet water temperature  
Ice production  
Refrigerating duty

Reamer speed  
Ice thickness  
Evaporating temperature  
Minimum condensing Temperature  
Maximum condensing Temperature  
Water flow  
Minimum water temperature  
Maximum water temperature

Nominal use **Selection N°1**

	R22
°C	15
T / 24h	<b>10,0</b>
KW	50,0
-	-
Tr/h	74
mm	2,3
°C	-21,00
* °C	30
** °C	55,00
L/h	417
°C	5
°C	30

**Selection N°2**

Nominal use

	R22
°C	15
T / 24h	<b>13,00</b>
KW	132,0
-	-
Tr/h	132
mm	1,8
°C	-23,0
* °C	30
** °C	55,0
L/h	541,7

\* Maximum for  
\*\* Minimum for

Oil return  
slugging limit risk

### DESCRIPTION OF EQUIPMENT

Refrigerant cylinder feeding Liquid level control, solenoid valve, throttle valve

**Double wall steel cylinder (machined, coating Genecoat® based on Ni-Cr plated)**

### ELECTRICAL DATAS

	Nominal power	Power supply	Nominal installed amperage	
1 Reamer motor	250 W	400V-3 <b>50 Hz</b>	0,95 A	
2 Pump	70 W	230V -1 <b>50 Hz</b>	0,35 A	
1 Solenoid valve	10 W	230V -1 <b>50 Hz</b>	0,10 A	Option(s) / 115V -1
1 Emergency stop				
1 Torque limiter switch	&	1 Electrical liquid level control (regulation)		
1 Salt dosing pump	-	50 W 230V -1 / 115V -1 <b>50 Hz</b>	0,40 A	

version	JAN -A-2017	<b>ICE GENERATOR</b>	<b>F600 ABF</b>	<b>R22</b>
Document type	Description D			
<b>TEC-GU-F 600 ABF-D- GB</b>				
Edition date	1.01.2017	<i>Photos and sketch are not contractual. Document can be modified without prior notice.</i>		

## DIMENSIONS AND CONNECTIONS

### Overall dimensions

Length	L mm	1550,00	D1 mm	300,00
Width	I mm	1200,00	D2 mm	1360,00
Height	H mm	2050,00	H1 mm	1550,00
Dimensions	a mm	147,00	H2 mm	1800,00
Dimensions	b mm	147,00	H3 mm	2050,00
Dimensions	c mm	147,00	E mm	1040,00
Volume	V m3	3,81	B mm	1040,00
Ice chute	G mm	780,00	Ø i mm	20,00
Net weight	Kg	979,00		

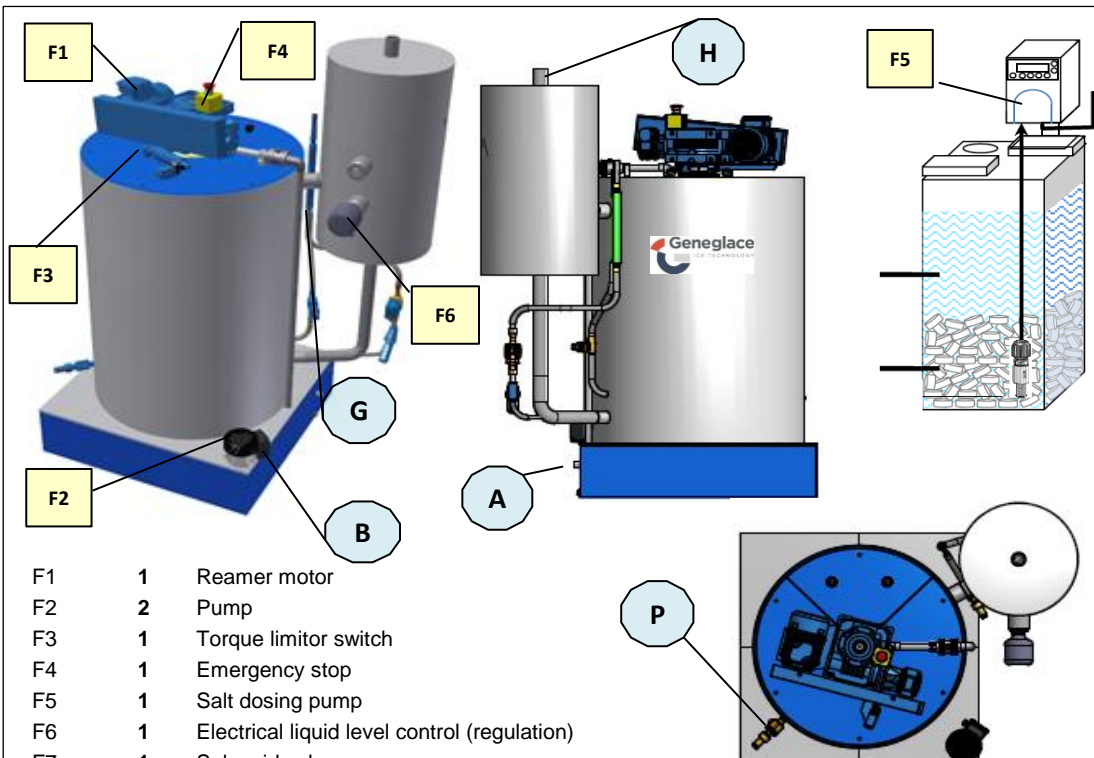
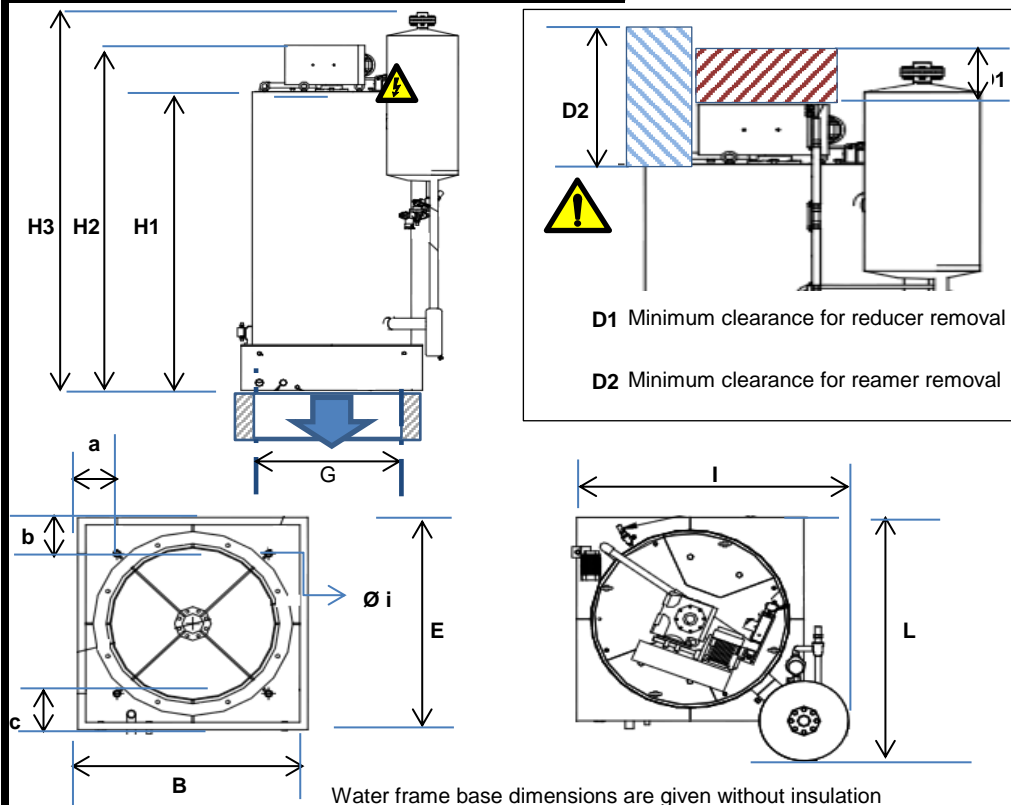

- |    |   |  |
|----|---|--|
| F1 | 1 | Reamer motor                                 |
| F2 | 2 | Pump   |
| F3 | 1 | Torque limiter switch                        |
| F4 | 1 | Emergency stop                               |
| F5 | 1 | Salt dosing pump                             |
| F6 | 1 | Electrical liquid level control (regulation) |
| F7 | 1 | Solenoid valve                               |

### Hydraulic connections

A	1	Generator water supply	Threated P.V.C	mm	1/2" G
B	1	Overflow + Water drainage	Plain ends tube	Steel	mm 1/2"
H	1	Suction	Plain ends tube	Steel	2"1/2
G/K	1	Liquid inlet	O.D.F	Copper	7/8"
I	1	Oil return	O.D.F	Copper	3/8"
P	1	Oil drain	O.D.M.-G	Stainless steel	3/8"

version	JAN -A-2017
Document type	Lay out E
TEC-GU-F 600 ABF-E- GB	
Edition date	1.01.2017

**ICE GENERATOR**

**F600 ABF**

**R22**

Photos and sketch are not contractual. Document can be modified without prior notice.

## REFRIGERATING SKETCH

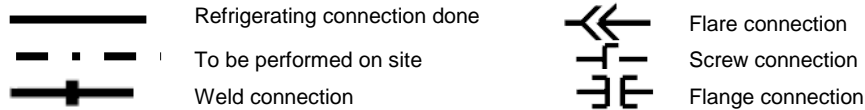
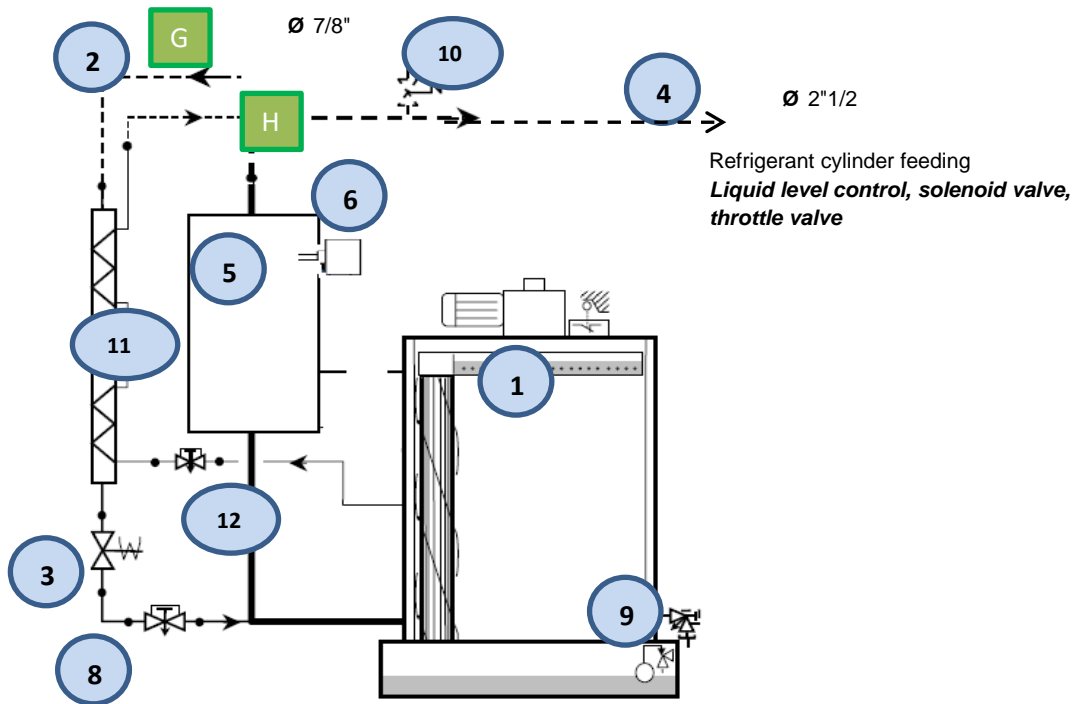

- 1 Flake ice generator
- 2 HP liquid inlet
- 3 Solenoid valve
- 4 Suction

- 5 Flood bottle
- 6 Level controller
- 8 Liquid inlet throttle valve

- 9 Oil drain
- 10 Safety pressure relief valve (out of supply)
- 11 Oil return exchanger

- 12 Oil return valve

*This sketch describes the Geneglance global supply from a refrigerating point of view, it only gives working principle and the real supply can vary according to the models and the application.*

version	JAN -A-2017
Document type	Refrigeration F
<b>TEC-GU-F 600 ABF-F- GB</b>	
Edition date	1.01.2017

**ICE GENERATOR**

**F600 ABF**

**R22**

*Photos and sketch are not contractual. Document can be modified without prior notice.*

CE

## MATERIAL DESCRIPTION

**Stainless steel**

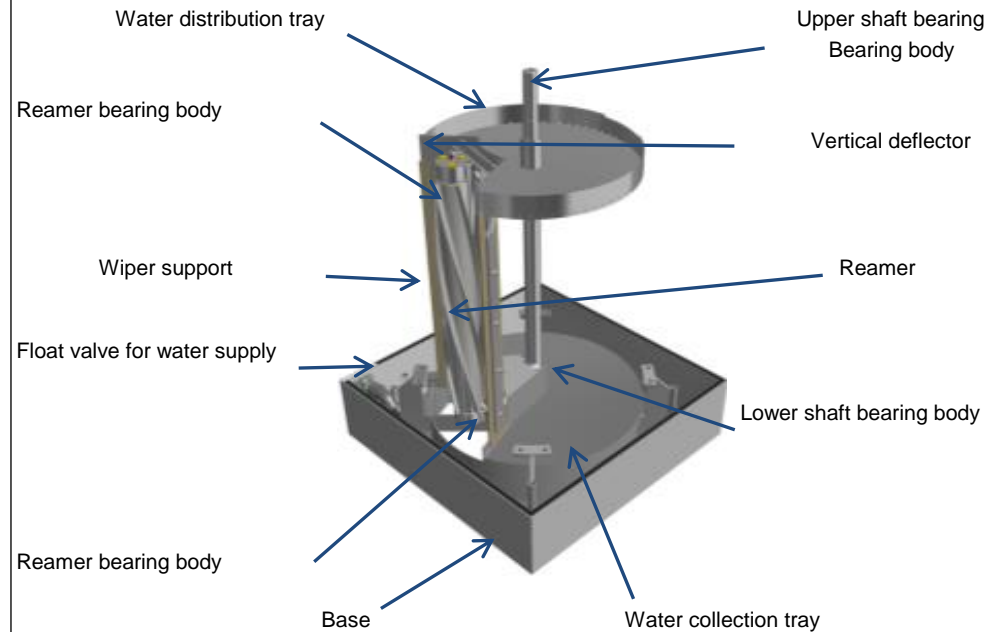

Global water path\*

**F600**

*\*(All parts in contact with water or ice)*

## INSTALLATION AND HANDLING

### HANDLING

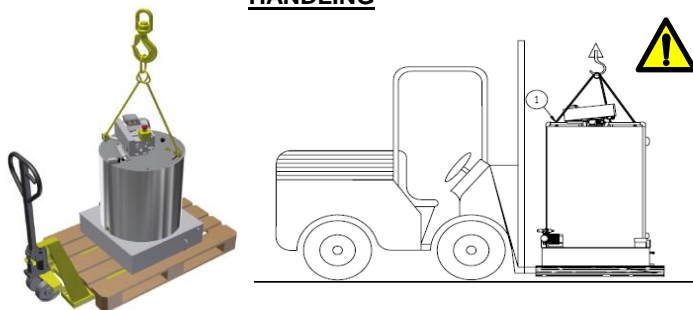

Lifting rings

Qty. 3

### TRANSPORT

#### Carton box

Volume 4,96 m<sup>3</sup>

Length mm 1680,0  
Width mm 1330,0  
Height mm 2220,0  
Net weight Kg 979,0  
Gross weight Kg 1120,0

This type of packing is generally used when goods are sent by air freight, by road or by sea freight. The sleeve box is hydrophobic and will resist to humidity.



	General information	Dimensions	
Power supply	Nominal use 400V-3	A mm	500,00
Frequency	50 Hz	B mm	1040,00
Refrigerant charge	100 Kg	C mm	500,00
Water pressure	2-4 bar	D mm	1700,00
Max working pressure :	1,85 Mpa (2014/68/UE )	E mm	1040,00
Net weight	979 Kg	L mm	1560,00
Max. water flow	590 L/h	I mm	1200,00
		k mm	170,00

### MINIMUM CLEARANCE FOR SERVICE

Dismantling and service area

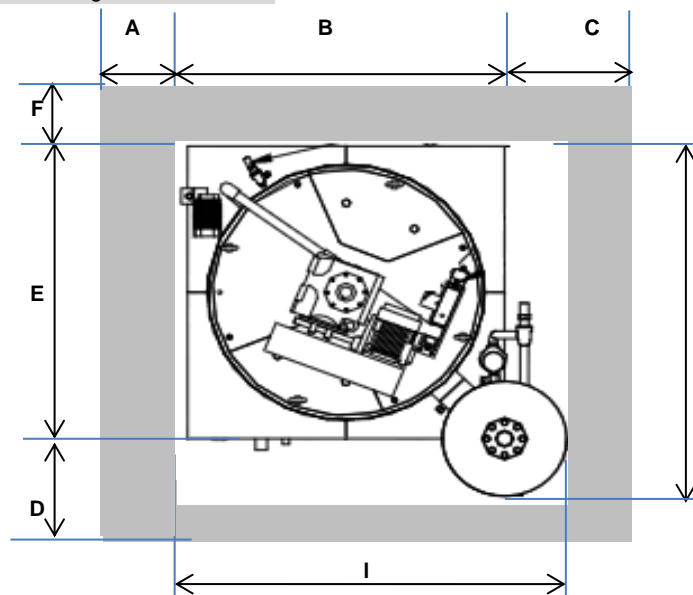

k : Fixation sleeves height of the base (Øi)

### INSTALLATION

Reserve enough clearance around the machine for maintenance (refer to Installation and Maintenance Guide)

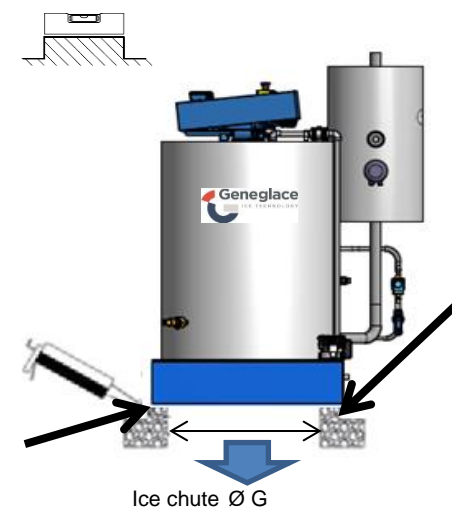

- (a) Tightness seal around the boring  
(b) Raising of the floor to avoid accidental water leaks in the storage

version	JAN -A-2017
Document type	Installation I
TEC-GU-F 600 ABF-I- GB	
Edition date	1.01.2017

Photos and sketch are not contractual. Document can be modified without prior notice.

## ICE GENERATOR

## F600 ABF

## R22

## SCOPE OF SUPPLY

### ICE GENERATOR

**Cylinder** 1,85 Mpa (2014/68/UE )  
 Double wall steel cylinder (machined, coating Genecoat® based on Ni-Cr plated)  
 Cylinder external insulation (injected polyurethane)  
 External insulation liner (White aluminium sheet)  
 Oil drain

#### Base

Generator base covers  
 Water flow reducer device  
 Water pump  
 Over flow + draining connection  
 Float valve for water supply  
 Stainless steel base without insulation  
 Connection pipe for water distribution

#### Revolving part

Central shaft (zinc plated, painted steel) revolving between two ball bearings  
 Lower water collection tray (stainless steel)  
 Upper water distribution tray (stainless steel)  
 Vertical deflector Stainless steel  
 Reamer adjuster with bolts and nuts  
 Helical reamer (stainless steel) between two ball bearings  
 Rubber wiper to limit the sprinkling area  
 Water distribution tray overflow also used for deglacing

#### Drive for revolving part

Torque limiter device with manual reset  
 Gear reducer with motor and belt

#### Refrigeration feeding

Flood bottle 1,85 Mpa (2014/68/UE )  
 Vertical bottle external insulation  
 Liquid level control, solenoid valve, throttle valve  
 Oil return device (halogen refrigerant only)  
 Liquid filter

#### Miscellaneous

1 Salt dosing pump



### Option(s)

Electrical control panel Protection IP 55  
 Remote control Protection IP 65  
 Electrical liquid level control (safety)  
*The Level controller will be installed on the flood bottle*  
 High ice level detector  
*Ice level detection will be installed in the ice storage*  
 Power supply 400V-3 50 Hz  
 460V-3 60 Hz

Salt dosing pump Protection IP 65 1,6A/20W

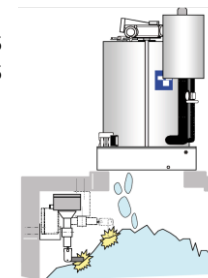

High ice level detector

#### CLEANING IN PLACE (CIP)

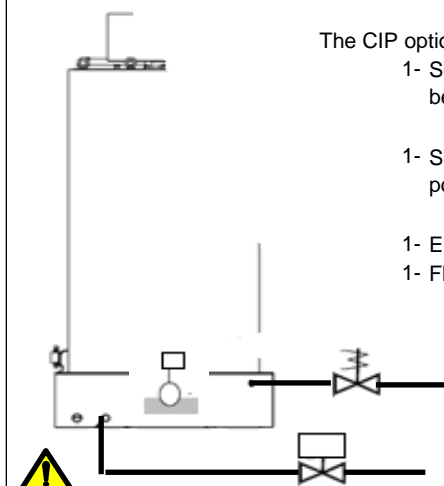

The CIP option includes the following components :

- 1- Solenoid valve that is fitted on the water supply line before the float valve (water supply control).
- 1- Servo-motorized valve that is installed on the draining point of the generator base (water drainage control).
- 1- Electrical control panel PVC
- 1- Float switch installed in generator base.



#### IMPORTANT :

The disinfectant used for cleaning should not form an emulsion and generate foam when pumped into the generator as well as not be corrosive or aggressive for the following materials : Stainless steel, chrome, natural rubber).

version	JAN -A-2017
	Scope of supply L
TEC-GU-F 600 ABF-L- GB	
Edition date	1.01.2017

### ICE GENERATOR

F600 ABF

R22

Photos and sketch are not contractual. Document can be modified without prior notice.

## DETAILED VIEW

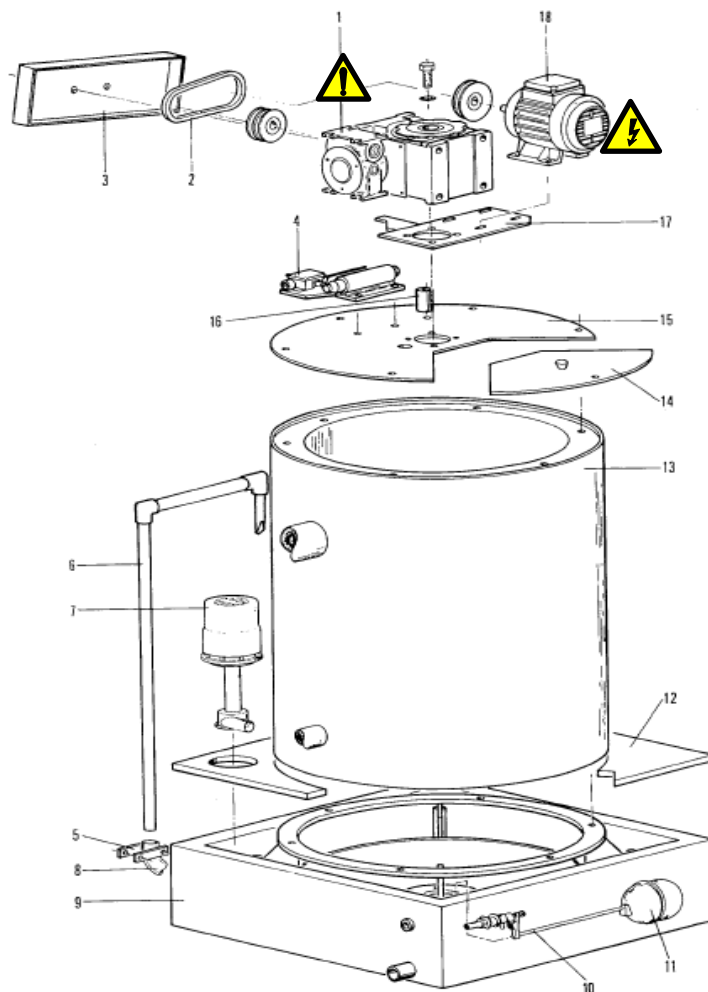

1 Gear reducer	
2 Belt	
3 Belt protection	X
4 Torque limiter	X
5 Water throttle valve	
7 Pump	
9 Base	X
10 Float valve for water supply	
12 Generator base covers	
13 Cylinder	Ni-Cr plated based - Genecoat® coating
14 Inspection hatch	X
15 Upper inspection cover	X
18 Reducer motor	
19 Upper shaft bearing	
20 Reamer bearing body	X
21 Reamer bearing cover	
23 Reamer bearing	
25 Reamer bearing body	X
26 Reamer	X
27 Complementary wiper fixation	
28 Complementary rubber wiper	
30 Lower shaft bearing	
32 Water collection tray	X
33 Rubber wiper	
34 Wiper support	
36 Main shaft	
38 Water distribution tray	X

Stainless steel  
304L

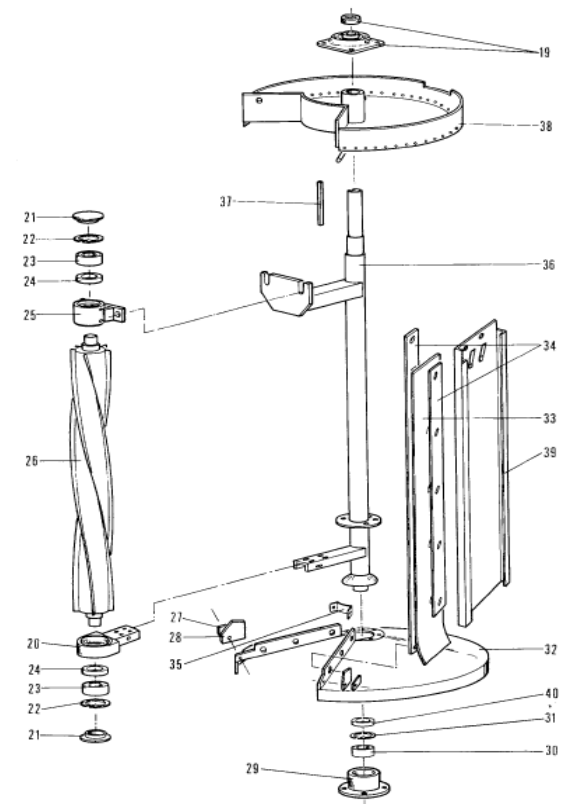

Note(s) Pulley and belt according to reamer speeds: Specify machine serial number

Specify the voltage and the frequency  
Specify the machine serial number

GENEGLACE may change this document without prior notice

version	JAN -A-2017
Document type	Exploded view V
<b>TEC-GU-F 600 ABF-V- GB</b>	
Edition date	1.01.2017

Photos and sketch are not contractual. Document can be modified without prior notice.

# ICE GENERATOR

# F600 ABF

# R22